

**FX, FX-EL INSTALLATION INSTRUCTIONS - PRIOR TO INSTALLATION REFER TO SAFETY NOTES FOR HIGH PROFILED ROOFING MATERIALS, INSTALLATION INSTRUCTION COMES WITH THE EH FLASHING KIT.**

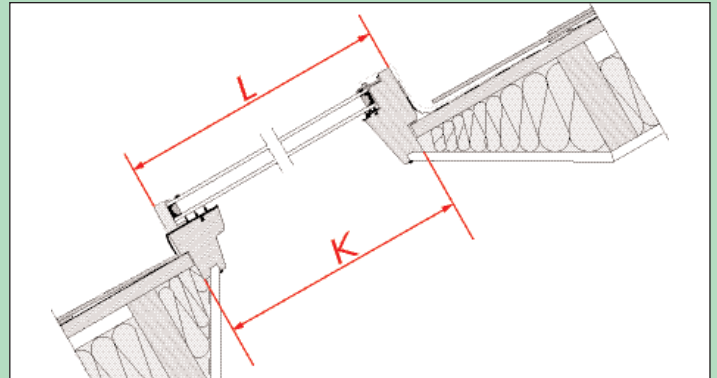
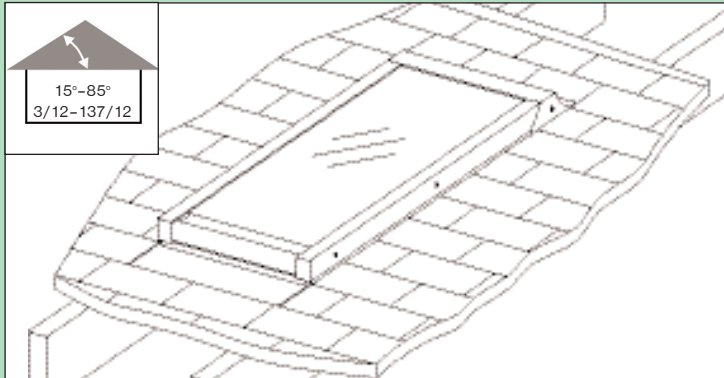

**FX-EL** - skylight includes flashing kit for flat roofing materials (one package)\*

**FX** - skylight (flashing in separate package)

**B x L** - outside frame

**S x K** - nominal skylight size

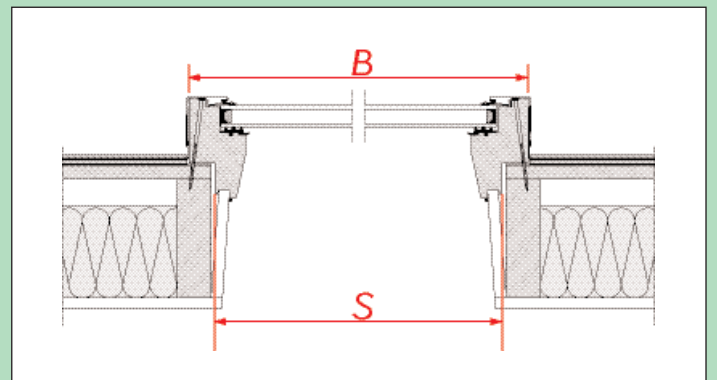

Skylight FX dimensions

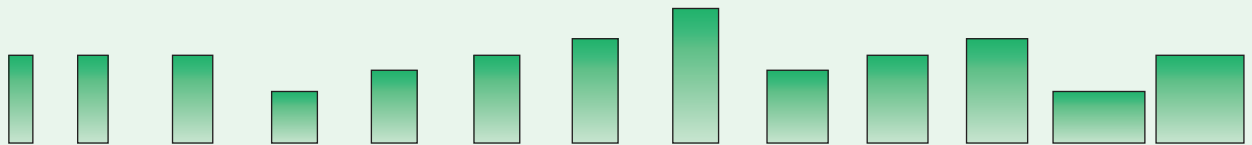

MODEL	13/46	16/46	21/46	24/27	24/38	24/46 *	24/55 *	24/70 *	32/38	32/46	32/55 *	48/27	48/46
Outside frame in.	13 1/2 x 46 3/8	16 1/2 x 46 3/8	21 1/2 x 46 3/8	24 1/2 x 27 1/2	24 1/2 x 38 1/2	24 1/2 x 46 3/8	24 1/2 x 55	24 1/2 x 70 3/4	32 1/2 x 38 1/2	32 1/2 x 46 3/8	32 1/2 x 55	48 1/2 x 27 1/2	48 1/2 x 46 3/8
BxL mm	343x1178	419x1178	546x1178	623x699	623x978	623x1178	623x1397	623x1797	826x978	826x1178	826x1397	1232x699	1232x1178
Nominal window size in.	11 1/2 x 45 1/8	14 1/2 x 45 1/8	19 1/2 x 45 1/8	22 1/2 x 26 3/4	22 1/2 x 37 1/4	22 1/2 x 45 1/8	22 1/2 x 54 1/8	22 1/2 x 70	30 1/2 x 37 1/4	30 1/2 x 45 1/8	30 1/2 x 54 1/8	46 1/2 x 26 3/4	46 1/2 x 45 1/8
SxK mm	292x1158	368x1158	495x1158	572x679	572x958	572x1158	572x1377	572x1777	775x958	775x1158	775x1377	1181x679	1181x1158

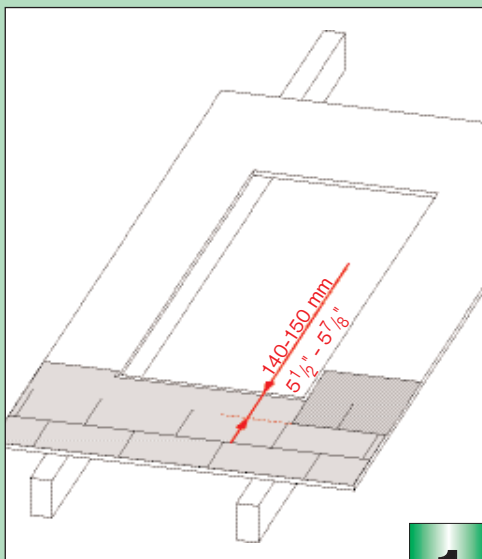

Set the gap between the bottom edge of the skylight frame and the roofing material as shown on the drawing.

**1**

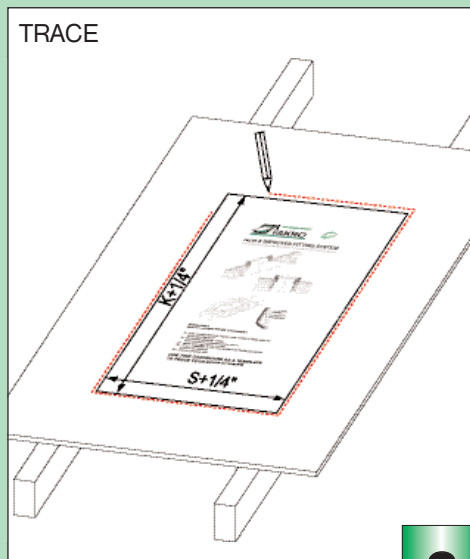

Using the attached templet mark the opening for the skylight.

**2**

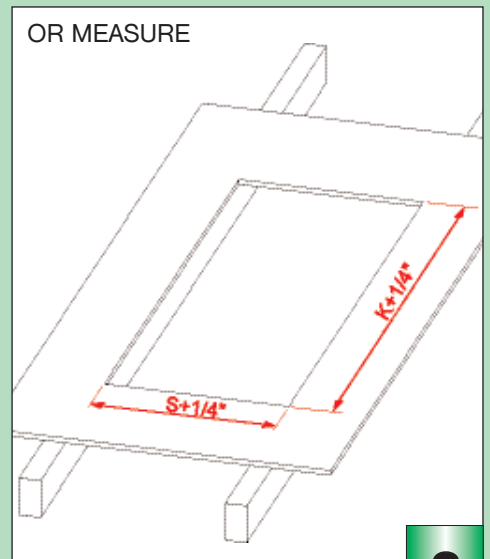

Cut out the hole according to the traced lines.

**3**

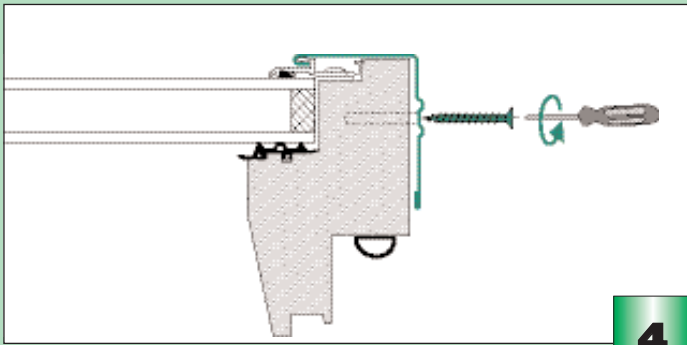

Remove the side aluminum profiles covering the frame.

**4**

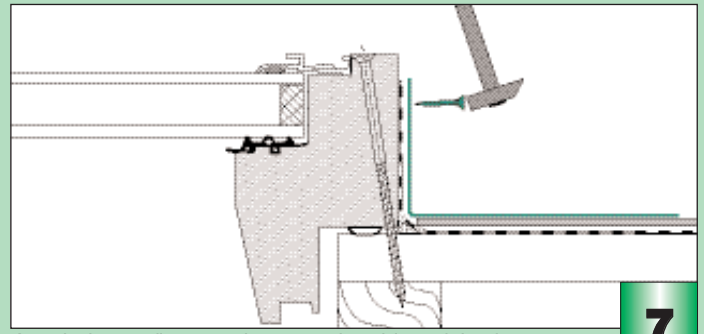

Attach the roofing membrane to the sides of the frame. Apply the side elements of the step flashing overlapping with shingles.

**7**

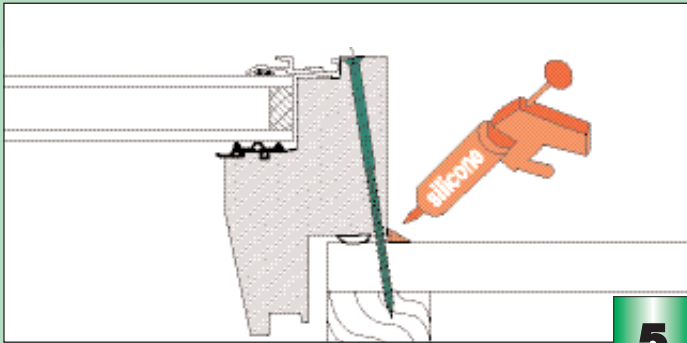

Position the skylight and secure it on both sides with provided screws, observing the pre-drilled holes. Apply roofing silicone around the frame of the skylight, sealing the gap between the boarding and the frame.

**5**

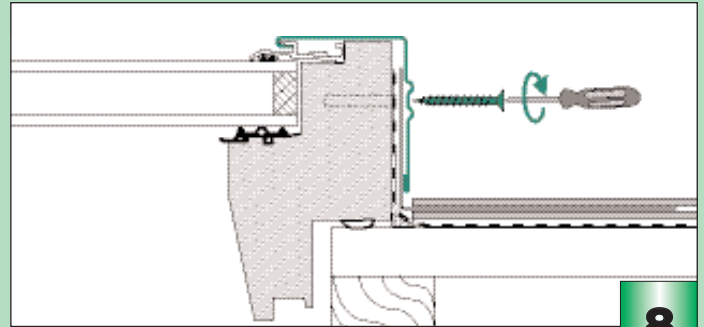

Replace the side aluminum profiles and secure them with screws.

**8**

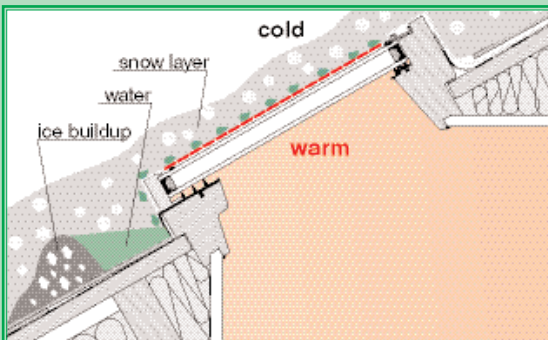

In areas with severe weather conditions, where thick layer of snow accumulates on the roof surface and remains there for long time, situation as depicted can take place. If such situation takes place an additional ice shield must be used. Ice shield available at your local skylight dealer.

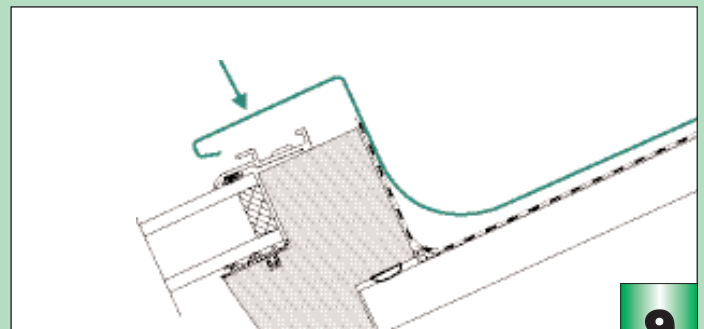

Attach the roofing membrane to the top of the frame. Position the top part of the flashing.

**9**

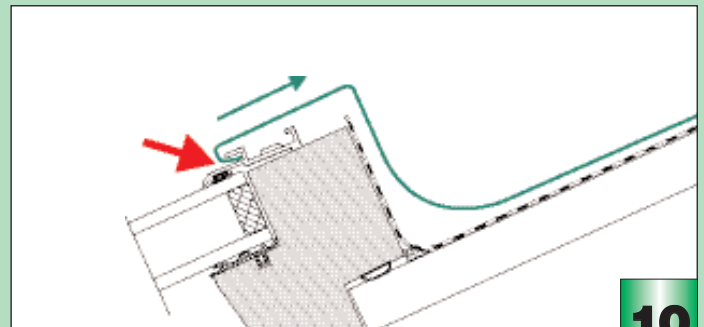

Make sure that the bent top part of the flashing overlaps with the aluminum strip.

**10**

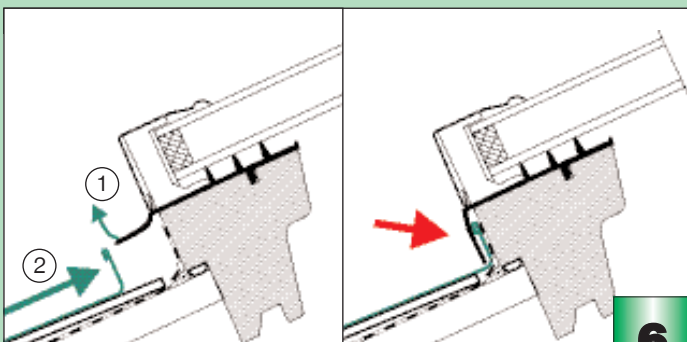

- Lift upwards the rubber gasket, position the roofing membrane and the bottom flashing.
- Make sure that the gasket overlaps the bottom aluminum profile (arrow).

**6**

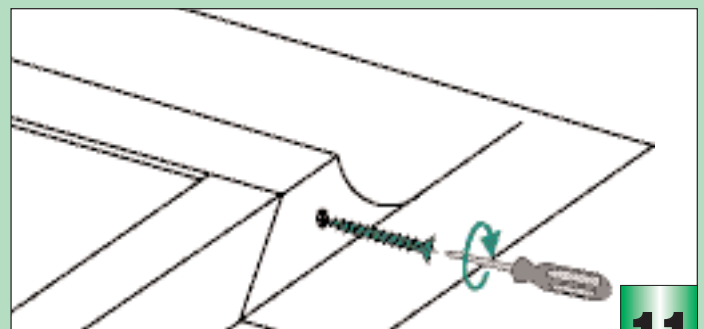

Secure both sides of the top flashing with screws.

**11**